



Force Multiplication through Information Technology®

► Production Facility

CCII Systems (Pty) Ltd (C²I² Systems) has its own purpose-built Production Facility for primary and secondary assembly as well as rework and repair of electronic board-level products. The facility is staffed by IPC-accredited operators, inspectors and technicians and support personnel.

The Production Facility is able to perform low rate and final assembly and a wide range of pre-shipment tests of printed wiring boards. It is also equipped to conformal coat various electronic board-level products with various conformal coating compounds used in the . All components are stored in the Production Facility storeroom.

The Production Facility includes a large testing area which is equipped with a wide range of standard and special test equipment, the latter which may be further modified based on the specific testing needs of the product. An Environmental Test Chamber is available for high and low temperature qualification and production atesting.

Production Facility Capabilities

- Electrostatic Discharge (ESD) Protected Area
- Solder Workstations
- Product Testing Area
- Environmental Test Chamber
- Conformal Coating Room
- Dark Room
- Rework Station
- Repair Station
- Product Storeroom
- Component Storeroom
- Shipping Station

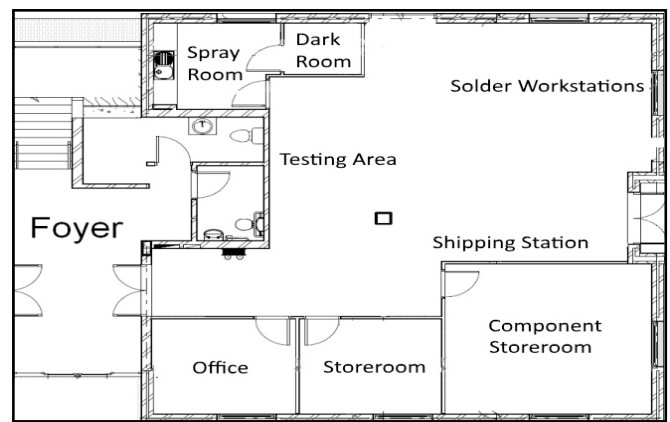

Production Facility Layout



Product Testing Area



Environmental Test Chamber



Solder Workstation



Repair Workstation